

# Bendable Serrated Aluminum Profile

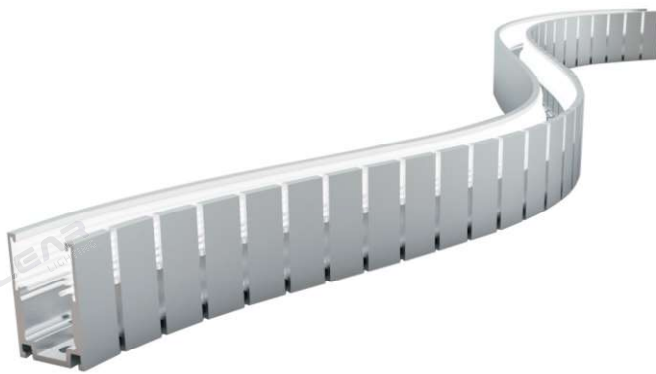

It is an expanded design of the serrated aluminum profile, and caters for the continuously streamlined aesthetics of curve shape. The secondary precision cutting process, not only maintains the advantage of clamping force, but also enables the two-way horizontal bending directions with super shape memory.

Please refer to the applicable installation ways.

Test Object	No.	Experiment Item	Standard
Metal Parts	1	Weather Resistance-Salt Spray	IEC 68-2-11
Mounting profile	2	Clamping force	CLEAR-defined

## Dimension: mm

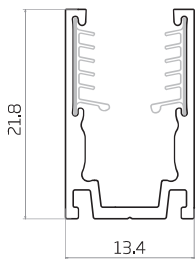

Tolerance:  $\pm 0.3\text{mm}$

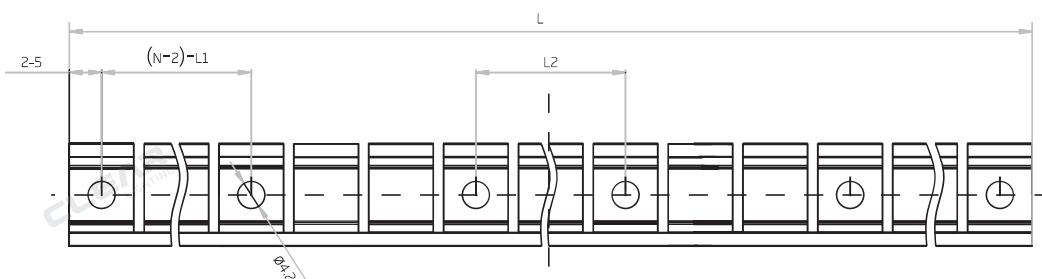
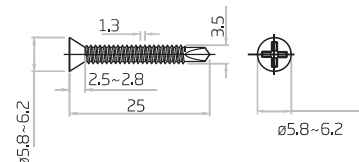
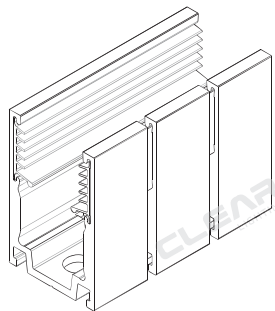

Note:

- 2-5 refers to two of symmetric 5mm in each piece of profile.
  - (N-2)-L1 refers to (N minus two) of symmetric L1 in each piece of profile.
- "N" hereby stands for its corresponding "Hole Number" in the below table

Item Code	Standard Length	L1	L2	Screw Hole	Hole Number
F10-BSA/PL-500MM-AL	500mm/19.68in	110.3mm/4.34in	48.9mm/1.92in	$\phi 4.2\text{mm}/0.17\text{in}$	6
F10-BSA/PL-1000MM-AL	1000mm/39.37in	116.5mm/4.59in	98.8mm/3.89in	$\phi 4.2\text{mm}/0.17\text{in}$	10

# Installation Instructions

Friendly Reminder: please read instructions carefully before operation.

CLEAR LIGHTING

## Bending Diameter

Min. Bending Diameter (Toothed Side inwards)

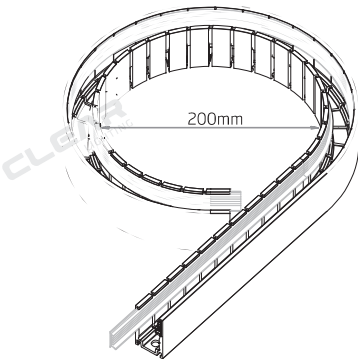

Min. Bending Diameter (Toothed Side outwards)

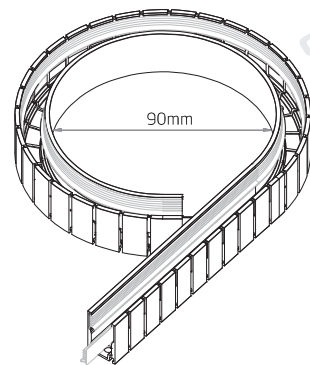

CLEAR LIGHTING

CLEAR LIGHTING

## Installation

▶ Step 1

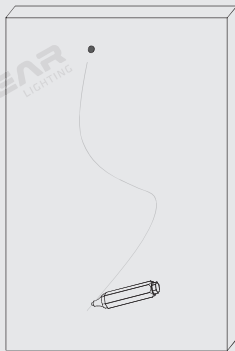

Mark the required shape on the mounting surface or print the sketch in the scale of 1:1 if complicated.

▶ Step 2

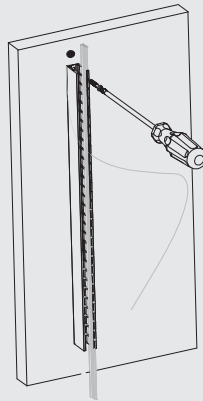

Get the front connector outside of profile and keep at least 10mm more apart. Fix the screw starting from the power input end.

▶ Step 3

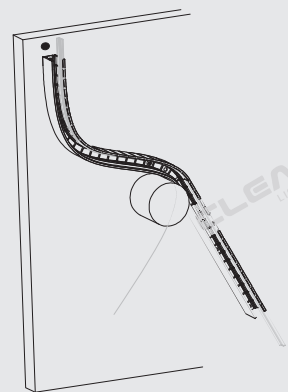

Use cylinder or disc-like object you have to assist with shaping.

▶ Step 4

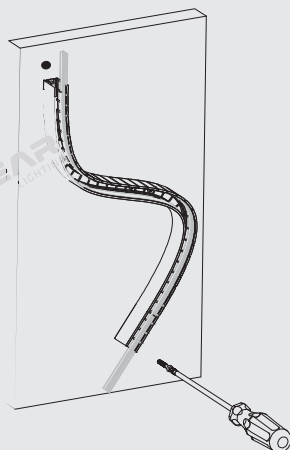

Fix the rest in sequence along with the marks.

▶ Step 5

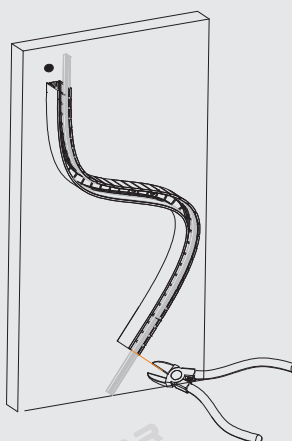

Adjust the serrate silicone tape and remove the redundant lengths at both ends.

▶ Step 6

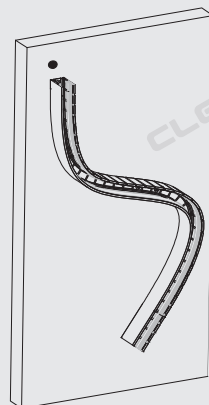

Finish and fix the light in.

CLEAR LIGHTING

CLEAR LIGHTING

CLEAR LIGHTING

CLEAR LIGHTING